

Mounting aid Safety PG HOLDER SLC

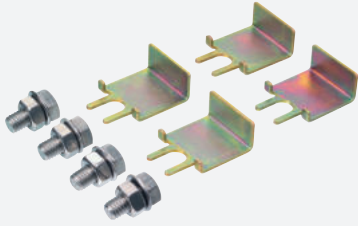

- Bracket for mounting the glass panel for the protection of the light outlet surface of safety light grids and curtains

Holders for SLC protective glass panes

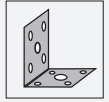

Dimensions

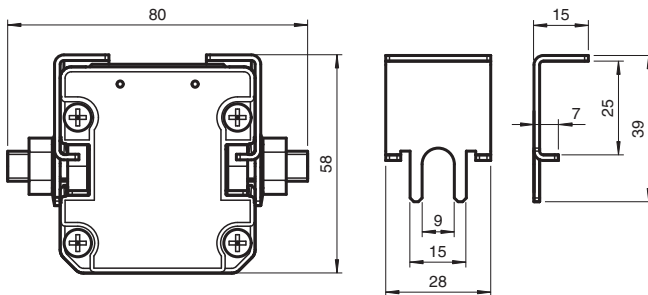

Technical Data

Ambient conditions	
Storage temperature	-40 ... 85 °C (-40 ... 185 °F)
Mechanical specifications	
Material	nickel-plated steel
Mounting	Mounting accessories included
Suitable series	
Safety Series	SLC

Release date: 2020-03-23 Date of issue: 2020-10-06 Filename: 111172_eng.pdf

Refer to "General Notes Relating to Pepperl+Fuchs Product Information".

Pepperl+Fuchs Group
www.pepperl-fuchs.com

USA: +1 330 486 0001
fa-info@us.pepperl-fuchs.com

Germany: +49 621 776 1111
fa-info@de.pepperl-fuchs.com

Singapore: +65 6779 9091
fa-info@sg.pepperl-fuchs.com

PEPPERL+FUCHS